

XP-70 HO

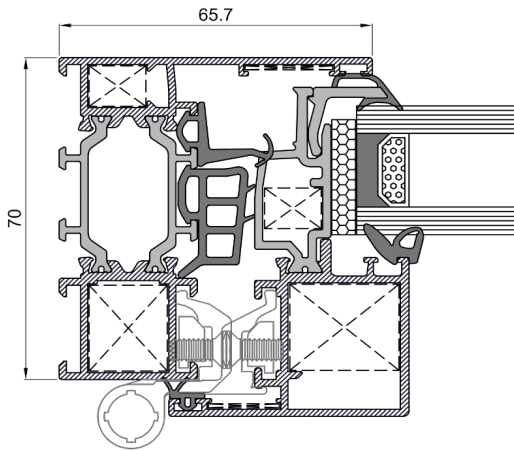

The XP-70 HO system, with a 70 mm of section and standard canal for eurogroove hardware, can be used in all types of projects while maintaining a minimalist design.



Technical data

Geometry and glazing

Frame	70 mm
Sash	71,5 mm
Thickness	1,5 mm
Polyamide frame	34 mm
Polyamide sash	40,3 mm
Sash glazing thickness	26-31 mm
Frame glazing thickness	7 - 52 mm

Maximum dimensions and weights*

Width	1.400 mm
High	2.500 mm
Visible hardware	130 kg/hoja
Concealed hardware	180 kg/hoja

*Consult maximum dimensions and weight according to typology.

Categories achieved at test centre :

Protection against atmospheric agents | Conducted by a notified institution

Reference test: window with 2 tilt-and-turn sashes 1230x1480 mm, 6-18-6 glass

Air permeability

Test according to UNE-EN 1026:2017
Clasificación according to UNE-EN 12207:2017

Class 1	Class 2	Class 3	Class 4
---------	---------	---------	----------------

Water tightness

Test according to UNE-EN 1027:2017
Clasificación according to UNE-EN 12208:2000

1A	2A	3A	4A	5A	6A	7A	8A	9A	E2400 *
----	----	----	----	----	----	----	----	----	----------------

E = categoría especial *
2400=pressure at which the window works

Wind resistance

Test according to UNE-EN 12211:2017
Clasificación according to UNE-EN 12210:2017

C1	C2	C3	C4	C5
----	----	----	----	-----------

Thermal transmittance | Energy efficiency:

Uf = 1,9 W/m²K

Uw ≥ 0,9 W/m²K *

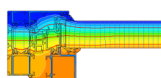

Window acoustic insulation:

Rw (C;Ctr):

48 (-1;-4)*

* Calculated value according to UNE-EN ISO 10077-2:2020 UNE-EN ISO 10077-1:2017 for 2 balcony sash window measuring 1480x2200 mm with triple low emissivity glass. Ug 0,5 W/m²K.

* Calculated value for a 2 sash window measuring 1230x1480 mm with glass 50 (-1;-5), consult Extrugasa for other types of glass or dimensions.

